

CFP-CF

NOMENCLATURA PARTI DI RICAMBIO

SPARE PARTS LIST

NOMENCLATURA REPUESTOS

NOMENCLATURE PIECES DE RECHANGE

ERSATZTEILLISTE

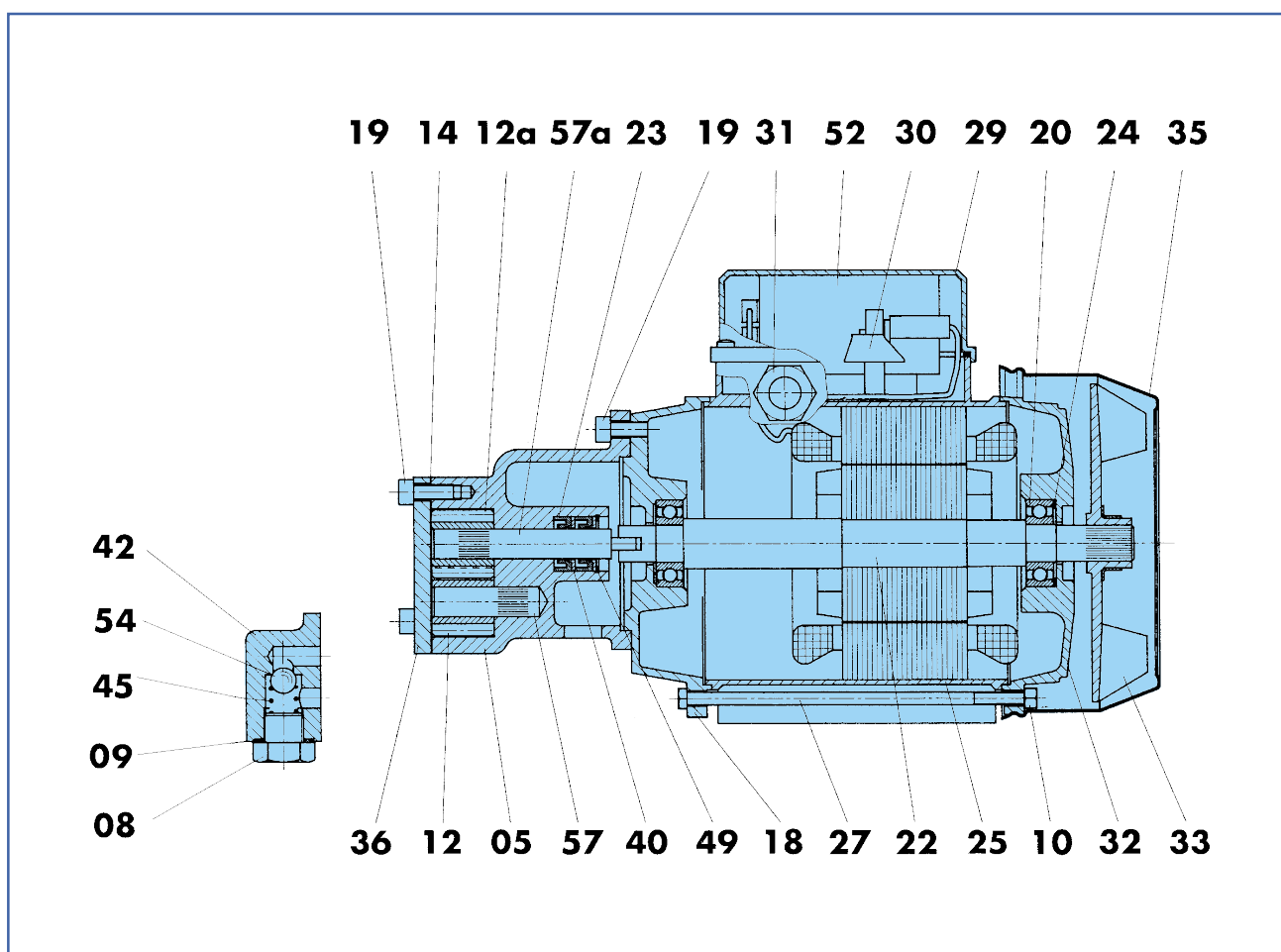



COMPONENTE		MATERIALI
05	Corpo pompa	Ghisa G20
10	Dado	Acciaio zincato
12	Ingranaggio condotto	Bronzo G-CuSn10
12a	Ingranaggio conduttore	Acciaio C40
14	Guarnizione	Flexoid
18	Calotta flangiata	Ghisa G20
19	Vite	Acciaio zincato
20	Cuscinetto	Commerciale
22	Albero rotore	Acciaio C40
23	Anello tenuta	Acciaio C40
24	Anello elastico	Acciaio
25	Carcassa statore avvolto	Alluminio
27	Tirante	Acciaio zincato
29	Coperchio morsettiera	Resina termoplastica
30	Morsettiera	Resina termoindurente
31	Pressacavo	Resina termoplastica
32	Calotta motore	Alluminio
33	Ventola	Resina termoplastica
35	Copriventola	Acciaio
36	Coperchio	Ghisa G20
40	Anello d'appoggio	Ottone
49	Anello seeger	Acciaio
52	Condensatore (solo monofase)	Commerciale
57	Perno fisso	Acciaio C40
57a	Perno rotante	Acciaio C40
	BY-PASS	BY-PASS
08	Tappo	Ottone
09	Guarnizione	Alluminio
42	Coperchio	Ghisa G20
45	Molla	Acciaio
54	Sfera	Acciaio



COMPONENT		MATERIAL
05	Pump body	Cast iron G20
10	Nut	Galvanized steel
12	Connection gear	Bronze G-CuSn10
12a	Connection gear	Steel C40
14	Gasket	Flexoid
18	Flanged cap	Cast iron G20
19	Screw	Galvanized steel
20	Bearing	Commercial
22	Rotor shaft	Steel C40
23	Seal ring	Steel C40
24	Circlip	Steel
25	Casing with wound stator	Aluminium
27	Tie-rod	Galvanized steel
29	Terminal board cover	Thermoplastic resin
30	Terminal board	Thermosetting resin
31	Fairlead	Thermoplastic resin
32	Driving cap	Aluminium
33	Fan	Thermoplastic resin
35	Fan cover	Steel
36	Cover	Cast iron G20
40	Support ring	Brass
49	Seeger	Steel
52	Capacitor (for single phase only)	Commercial
57	Fixed stud	Steel C40
57a	Rotating stud	Steel C40
	BY-PASS	BY-PASS
08	Plug	Brass
09	Gasket	Aluminium
42	Cover	Cast iron G20
45	Spring	Steel
54	Sphere	Steel

CFP-CF



NOMENCLATURA PARTI DI RICAMBIO
SPARE PARTS LIST
NOMENCLATURA REPUESTOS
NOMENCLATURE PIECES DE RECHANGE
ERSATZTEILLISTE

	COMPONENTE	MATERIAL
05	Cuerpo de bomba	Fundición gris G20
10	Tuerca	Acero cincado
12	Engranaje conducto	Bronce G-CuSn10
12a	Engranaje conductor	Acero C40
14	Empaquetadura	Flexoid
18	Tapa rebordeada	Fundición gris G20
19	Tornillo	Acero cincado
20	Cojinete	Comercial
22	Eje rotor	Acero C40
23	Anillo aislador	Acero C40
24	Anillo elastico	Acero
25	Carcasa de bobinado envuelto	Aluminio
27	Tirante	Acero cincado
29	Tapa de bornes	Resina termoplastica
30	Bornes	Resina de endurecimiento termico
31	Guia	Resina termoplastica
32	Tapa motor	Aluminio
33	Ventilador	Resina termoplastica
35	Tapa ventilador	Acero
36	Tapa	Fundición gris G20
40	Anillo de apoyo	Latón
49	Anillo seeger	Acero
52	Condensador (solo monofásico)	Comercial
57	Perno fijo	Acero C40
57a	Perno rotatorio	Acero C40
	BY-PASS	BY-PASS
08	Tapon	Latón
09	Empaquetadura	Aluminio
42	Tapa	Fundición gris G20
45	Muelle	Acero
54	Bola	Acero

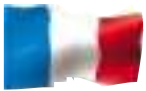

COMPOSANT		MATÉRIAUX
05	Corps de pompe	Fonte G20
10	Ecrou	Acier zingué
12	Engrenage conduit	Bronze G-CuSn10
12a	Engrenage conducteur	Acier C40
14	Joint	Flexoid
18	Calotte bridée	Fonte G20
19	Vis	Acier zingué
20	Roulement	Commerciale
22	Arbre rotor	Acier C40
23	Bague garniture	Acier C40
24	Bague élastique	Acier
25	Carcasse stator enroulé	Aluminium
27	Tirant	Acier zingué
29	Couvercle plaque à borne	Résine thermoplastique
30	Plaque à borne	Résine thermo-endurci
31	Presse-câble	Résine thermoplastique
32	Calotte moteur	Aluminium
33	Ventilateur	Résine thermoplastique
35	Couvercle ventilateur	Acier
36	Couvercle	Fonte G20
40	Bague d'appui	Laiton
49	Bague seeger	Acier
52	Condensateur (seulement pour monophasé)	Commerciale
57	Axe fixe	Acier C40
57a	Axe roulant	Acier C40
	BY-PASS	BY-PASS
08	Bouchon	Laiton
09	Joint	Aluminium
42	Couvercle	Fonte G20
45	Ressort	Acier
54	Billie	Acier



BAUTEIL		WERKSTOFFE
05	Pumpengehäuse	Gusseisen G20
10	Mutter	Verzinkter Stahl
12	Angetriebenes rad	Bronze G-CuSn10
12a	Antriebsrad	Stahl C40
14	Dichtung	Flexoid
18	Geflanschte motorkappe	Gusseisen G20
19	Schraube	Verzinkter Stahl
20	Lagerbuchse	Handelsüblich
22	Rotorwelle	Stahl C40
23	Dichtring	Stahl C40
24	Spannring	Stahl
25	Motorgehäuse mit wickelstator	Aluminium
27	Verbindungsschraube	Verzinkter Stahl
29	Klemmenplattendeckel	Thermoplast
30	Klemmenplatte	Härtbares Stahl
31	Kabeldruck	Thermoplast
32	Motorkappe	Aluminium
33	Lüfterrad	Thermoplast
35	Lüfterradabdeckung	Stahl
36	Deckel	Gusseisen G20
40	Stützring	Messing
49	Seeger	Stahl
52	Kondensator (nur für einphasige Ausführung)	Handelsüblich
57	Drehbolzen	Stahl C40
57a	Rotierender Bolzen	Stahl C40
	BY-PASS	BY-PASS
08	Stopfen	Messing
09	Dichtung	Aluminium
42	Deckel	Gusseisen G20
45	Feder	Stahl
54	Kugel	Stahl